

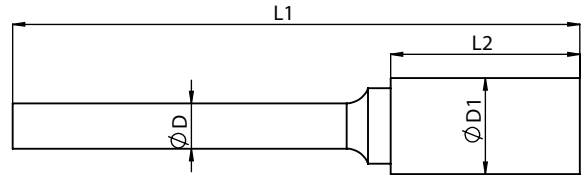

SA

Cylindrical without end cut

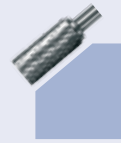

3 mm Shank					Standard cut (Single cut)	Supreme cut (Double cut)	Deluxe cut (Diamond cut)	Aluma Cut	Coarse Cut	CTI Number
Head Diameter	Head length	Overall Length	Shank Dia	Tool No	EDP No.	EDP No.	EDP No.	EDP No.	EDP No.	
ØD1	L2	L1	D		EDP No.	EDP No.	EDP No.	EDP No.	EDP No.	
3	16	38	3	MC1*	FAC0200563	FAC0200565	FAC0200566	-	-	SA-43M
3	16	50	3	MC1L*	FAC0200567	FAC0200568	FAC0200569	-	-	SA-43ML2
3	16	75	3	MC1L1*	FAC0200570	FAC0200571	FAC0200572	-	-	SA-43ML3
6.3	6.3	32	3	MC2	FAC0200573	FAC0200574	FAC0200575	-	-	-
6.3	6.3	50	3	MC2L	FAC0200576	FAC0200577	FAC0200578	-	-	-
6.3	6.3	75	3	MC2L1	FAC0200579	FAC0200580	FAC0200581	-	-	-
6.3	12.7	38	3	MC3	FAC0200582	FAC0200583	FAC0200584	-	-	SA-51M
1.5	6	38	3	MC4*	FAC0200585	FAC0200586	FAC0200587	-	-	SA-41M
1.5	6	50	3	MC4L*	FAC0200588	FAC0200589	FAC0200590	-	-	SA-41ML2
1.5	6	75	3	MC4L1*	FAC0200591	FAC0200592	FAC0200593	-	-	SA-41ML3
2.5	11	38	3	MC5*	FAC0200594	FAC0200595	FAC0200596	-	-	SA-42M
2.5	11	50	3	MC5L*	FAC0200597	FAC0200598	FAC0200599	-	-	SA-42ML2
2.5	11	75	3	MC5L1*	FAC0200600	FAC0200601	FAC0200602	-	-	SA-42ML3

6 mm Shank					Standard cut (Single cut)	Supreme cut (Double cut)	Deluxe cut (Diamond cut)	Aluma Cut	Coarse Cut	CTI Number
Head Diameter	Head length	Overall Length	Shank Dia	Tool No	EDP No.	EDP No.	EDP No.	EDP No.	EDP No.	
ØD1	L2	L1	D		EDP No.	EDP No.	EDP No.	EDP No.	EDP No.	
3	12.7	50	6	C0	FAC0200208	FAC0200209	FAC0200210	-	-	SA-11M
3.8	14	50	6	C1	FAC0200211	FAC0200212	FAC0200213	-	-	SA-13M
6	20	50	6	C2 FC*	FAC0200220	FAC0200221	FAC0200222	-	-	-
6	20	70	6	C2	FAC0200226	FAC0201365	FAC0200227	-	-	-
8	19	69	6	C3	FAC0200236	FAC0200237	FAC0200238	FAC0200245	-	SA-2M
9.5	19	69	6	C4	FAC0200246	FAC0200247	FAC0200249	FAC0200258	-	SA-3M
12.7	19	69	6	C5	FAC0200259	FAC0200263	FAC0200265	FAC0201320	-	-
16	25	75	6	C6	FAC0200273	FAC0200275	FAC0200277	FAC0200279	-	SA-6M
12.7	14	64	6	C7	FAC0200281	FAC0200282	FAC0200283	FAC0200284	-	-
12.7	25	75	6	C8	FAC0200285	FAC0200286	FAC0200287	FAC0200292	-	SA-5M
19	25	70	6	C9	FAC0200294	FAC0200296	FAC0200298	FAC0201314	-	SA-7M
25	25	75	6	C10	FAC0200300	FAC0200302	FAC0200304	FAC0201315	-	SA-9M
5	16	66	6	C11	FAC0200306	FAC0200307	FAC0200308	-	-	SA-14M
6.3	16	66	6	C12	FAC0200309	FAC0200310	FAC0200311	-	-	SA-1M
10	25	75	6	C13	FAC0200312	FAC0200313	FAC0200314	-	-	-
11	25	75	6	C14	FAC0200315	FAC0200316	FAC0200317	-	-	SA-4M

* indicates full carbide burrs

Note:

- Ask your local representative about our long shank program –Available in 4",5",6",7",8",9"10",11"& 12"
- All sizes available as a special in left hand cut
- Coarse cut burrs available on request



SA

Cylindrical without end cut

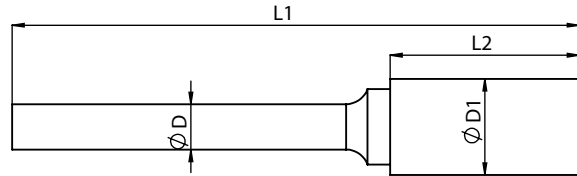

CARBIDE BURRS



8 mm Shank				Tool No	Standard cut (Single cut)	Supreme cut (Double cut)	Deluxe cut (Diamond cut)	Aluma Cut	Coarse Cut	CTI Number
Head Diameter	Head length	Overall Length	Shank Dia		EDP No.	EDP No.	EDP No.	EDP No.	EDP No.	
ØD1	L2	L1	D							
9.5	19	69	8	C4Z	FAC0201858	FAC0200248	FAC0201859	-	-	SA-3M8
12.7	19	69	8	C5Z	FAC0200261	FAC0200264	FAC0200266	-	-	-
16	25	75	8	C6Z	FAC0200274	FAC0200276	FAC0200278	-	-	SA-6M8
19	25	75	8	C9Z	FAC0200295	FAC0200297	FAC0200299	-	-	SA-7M8
25	25	75	8	C10Z	FAC0200301	FAC0200303	FAC0200305	-	-	SA-9M8

1/8 inch Shank				Tool No	Standard cut (Single cut)	Supreme cut (Double cut)	Deluxe cut (Diamond cut)	Aluma Cut	Coarse Cut	CTI Number
Head Diameter	Head length	Overall Length	Shank Dia		EDP No.	EDP No.	EDP No.	EDP No.	EDP No.	
1/16	1/4	1-1/2	1/8	MC4I*	FAC0201966	FAC0201968	FAC0201967	-	-	SA-41
3/32	7/16	1-1/2	1/8	MC5I*	FAC0201969	FAC0201971	FAC0201970	-	-	SA-42
1/8	9/16	1-1/2	1/8	MC1I*	FAC0201957	FAC0201959	FAC0201958	-	-	SA-43
1/4	1/2	2	1/8	MC3I	FAC0201963	FAC0201965	FAC0201964	-	-	SA-51
1/4	1/4	1-1/2	1/8	MC2I	FAC0201960	FAC0201962	FAC0201961	-	-	-

1/4 inch Shank				Tool No	Standard cut (Single cut)	Supreme cut (Double cut)	Deluxe cut (Diamond cut)	Aluma Cut	Coarse Cut	CTI Number
Head Diameter	Head length	Overall Length	Shank Dia		EDP No.	EDP No.	EDP No.	EDP No.	EDP No.	
1/8	5/8	2	1/4	C1I	FAC0201849	FAC0201851	FAC0201850	-	-	SA-12
3/16	5/8	2	1/4	C11I	FAC0201840	FAC0201842	FAC0201841	-	-	SA-14
1/4	5/8	2	1/4	C12I	FAC0201843	FAC0201845	FAC0201844	-	-	SA-1
5/16	3/4	2-1/2	1/4	C3I	FAC0201852	FAC0201854	FAC0201853	-	-	SA-2
3/8	3/4	2-1/2	1/4	C4I	FAC0201855	FAC0201857	FAC0201856	-	-	SA-3
7/16	1	2-3/4	1/4	C14I	FAC0201846	FAC0201848	FAC0201847	-	-	SA-4
1/2	1	2-3/4	1/4	C8I	FAC0201863	FAC0201865	FAC0201864	-	-	SA-5
5/8	1	2-3/4	1/4	C6I	FAC0201860	FAC0201862	FAC0201861	-	-	SA-6
3/4	1	2-3/4	1/4	C9I	FAC0201866	FAC0201868	FAC0201867	-	-	SA-7
1	1	2-3/4	1/4	C10I	FAC0201837	FAC0201839	FAC0201838	-	-	SA-9

* indicates full carbide burrs

Note:

- Ask your local representative about our long shank program –Available in 4", 5", 6", 7", 8", 9", 10", 11" & 12"
- All sizes available as a special in left hand cut
- Coarse cut burrs available on request